

A	---	New Release		P.T	M.L	11/18/2014
REV	ECN NO	Description		Made by	Approve	Date
				MOTECH MOTOR CO.,LTD		
			Scale			
				Hybrid Stepper Motor		
				MT-1704HS168A-TS		
Des.	Check	Appr.	Date	Factory Code		page

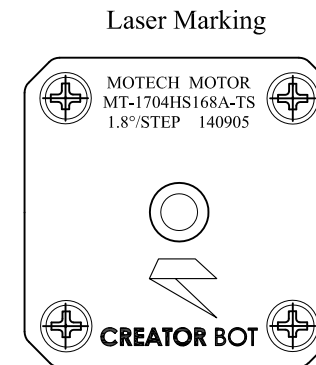
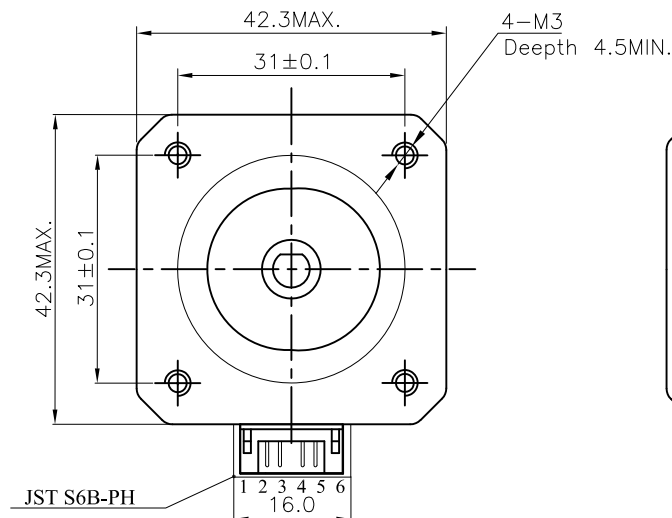
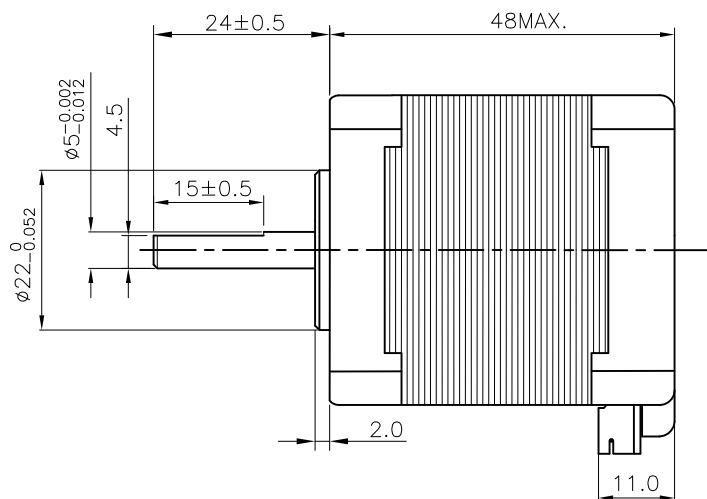

Items	Specs	Items	Specs
Phase Number	2 phases	Step Angle	1.8°±5%
Rated Voltage	2.8 VDC	Rated Current	DC 1.68 A / Phase
Resistance(20°C)	1.65±10% Ω / phase	Inductance	2.8±20% mH / Phase
Holding Torque	≥ 5.5 Kg-cm(77 Oz-in)	Detent Torque	0.2 Kg-cm REF.
Rotate Direction	ABCD CW	MAX Starting PPS	2500 PPS
MAX slewing PPS	2500 PPS	Insulation Resistance	≥100 MΩ(DC 500V)
HI POT	AC600V/1mA/1S	Insulation Class	Class B
Rotor Inertia	68 g.cm ²	Weight	0.35 Kg REF.

Cables

UL1007 24AWG
with PVC tube

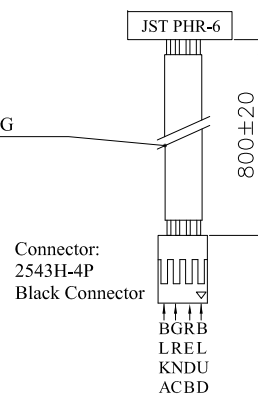

Wiring Diagram

